



HF-Regulator II for TL5 lamps

HF-Regulator 424 TL5/PL-L EII 220-240V 50/60Hz

Flat, lightweight high-frequency electronic regulating ballast, using 1-10V protocol for TL5 fluorescent lamps

Product data

• Product Data

Order code	913746 30
Full product code	871150091374630
Full product name	HF-R 424 TL5/PL-L EII 220-240V 50/60Hz
Order product name	HF-R 424 TL5/PL-L EII 220-240V 50/60Hz
Pieces per pack	1
Packing configuration	10
Packs per outerbox	10
Bar code on pack - EAN1	8711500913746
Bar code on outerbox - EAN3	8711500913753
Logistic code(s) - 12NC	913700614866
Net weight per piece	0.385 kg

• General Characteristics

Interface	1-10V
Rated Number of Lamps	4 piece
Rated Ballast-Lamp Power	24
Rated Lamptype	TL5/PL-L
Application code	EII
Line Voltage	220-240 V
Line Frequency	50-60 Hz
Housing	L 359x39x22
Ignition Method	Programmed Start
Lifetime 90% surv.@Tcaselife	50000 hr
Energy Efficiency Index	A1

• Operating Characteristics

Automatic restart	Yes
Battery voltage running lamps	154-276
Battery voltage lamp ignition	196 V
Control input protection	Yes
Inrush current Peak	45 (max) A
Inrush current Width	0.40 ms
Maximum ballast number on MCB	12 (max) x
Earth leakage current (AC)	0.5 (max) mA
Mains voltage safety (AC)	-10%/+10%
Mains voltage performance (AC)	-8%/+6%
Overvoltage protection 320Vac	48 hr
Overvoltage protection 350Vac	2 hr
PowerFactor 100% output power	0.95 -
Power losses gear	16.4 W
Regulating level power	1%-100%
Stable lamp operation temp.	- [Not specified]
Ballast Lumen Factor	1.00 -
Crestfactor	1.7 (max) -
Ignition time	0.2 (max) s
Operating frequency	84 (max) kHz
Total Harmonic Distortion EUR	4 %
Hum and Noise level	Inaudible

PHILIPS

sense and simplicity

HF-Regulator II for TL5 lamps

• Wiring Characteristics

Conn.type input terminals	WAGO 251 universal connector [Suitable for both automatic wiring (ALF and ADS) and manual wiring]
Conn.type output terminals	WAGO 251 universal connector [Suitable for both automatic wiring (ALF and ADS) and manual wiring]
Conn.type ctrl input terminals	WAGO 251 universal connector [Suitable for both automatic wiring (ALF and ADS) and manual wiring]
Striplength	8.0-9.0 mm
Dual fixture Master/Slave	- [not specified]
Wcs Control input terminals	0.50-1.00 mm ²
Wcs Input terminals	0.50-1.00 mm ²
Wcs Output terminals	0.50-1.00 mm ²
Wcs auto insertion (ALF/ADS)	0.5 mm ²

• Temperature Characteristics

T-case life	75 (max) C
T-case maximum	85 (max) C
T-ignition	0 (min), 50 (max) C
T-ambient	-20 (min), 50 (max) C
T-storage	-25 (min), 80 (max) C

• Approval & Application Char's

EMI 9kHz .. 30 MHz EN 55015

EMI 30 MHz .. 1000MHz	EN 55022 level B [Level = Class]
Safety Standard	IEC 61347-2-3
Performance Standard	IEC 60929
Quality Standard	ISO 9000:2000
Environmental Standard	ISO 14001
Harmonic current emissions	IEC 61000-3-2
EMC Immunity	IEC 61547
Vibrations	IEC 68-2-6 Fc
Bumps	IEC 68-2-29 Eb
Humidity	EN 61347-2-3 clause 11
Approval marks	ENEC / VDE-EMV
CE marking	Yes
Temperature marking	110 [Yes]
Emergency standard	IEC 60598-2-22

• Product Dimensions

Length A1	359 mm
Fixing Hole Distance	350 mm
Length A2	
Width B1	39 mm
Height C1	22 mm
Fixing Hole Diameter D1	4.2 mm

Dimensional drawing

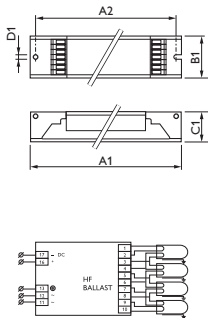

Product	A1 (Norm)	A2 (Norm)	B1 (Norm)	C1 (Norm)	D1 (Norm)
HF-R 424 TL5/PL-L EII 220-240V 50-60Hz	359	350	39	22	4.2



© 2011 Koninklijke Philips Electronics N.V.
All rights reserved.

Specifications are subject to change without notice. Trademarks are the property of Koninklijke Philips Electronics N.V. or their respective owners.

www.philips.com/lighting

2011, April 7
data subject to change